

WORD  
WITHIN THE  
WORD

# Plenary Speaker D.A. Carson

Renowned New Testament scholar D. A. Carson is the plenary speaker for the Ryan Center's 2009 Bible Conference "Word Within the Word". It is a great privilege and honor to be hosting Dr. Carson, a widely popular teacher, speaker, and writer.

Carson has written or edited more than 45 books including *The Gagging of God: Christianity Confronts Pluralism* (Zondervan 1996), which won the 1997 Evangelical Christian Publishers Association's Gold Medallion Book Award in the category "theology and doctrine."

Additionally Carson has been a pastor, seminary professor, book series editor, journal editor, and the founding dean of the seminary at Northwest Baptist Theological College in Vancouver.

He received the Master of Divinity degree from Central Baptist Seminary in Toronto, and a Ph.D. in New Testament from Cambridge University.



**D.A. Carson**

An insightful reviewer summarized Carson this way: "Professor Carson possesses qualities which are not often found in combination. He is a New Testament scholar who sees the Bible as a whole; a biblical scholar with a concern for both the theological and the practical implications of the Bible's teaching; a blunt writer with a pastoral heart; and (perhaps rarest of all) an academic with a clear, vigorous, occasionally even slangy style." (Paul Ellingworth, *Evangelical Quarterly* 64, 1992).

## Short Sample of Carson's Writings:

*Matthew (Expositor's Bible Commentary)* Zondervan, 1984

*John (Pillar NT Commentary)* Eerdmans, 1991

*A Call to Spiritual Reformation*, Baker, 1992

*The Cross & Christian Ministry: Studies in 1 Corinthians*, Baker, 1993

*Basics for Believers: An Exposition of Philippians*, Baker, 1996

*The Difficult Doctrine of the Love of God*, Crossway Books, 2000

*How Long, O Lord?: Reflections on Suffering and Evil*, Baker, 2006

*Christ and Culture Revisited*, Eerdmans, 2008

*Memoirs of an Ordinary Pastor: The Life and Reflections of Tom Carson*, Crossway, 2008



## Directions to Union University

*The directions given below will take you to the Union University Campus. For directions to conference parking and registration refer to the instructions on the campus map provided.*

### **Westbound Interstate 40 to Exit 80 B (from Nashville):**

Veer right at the exit ramp for Vann Drive and turn right at the four-way stop. At the next traffic light (Chick-Fil-A will be on the right), turn right onto Vann Drive and stay in the right lane. Go through two traffic lights. Go past Perkins Restaurant and Red Robin. Turn right at the third light onto Pleasant Plains. Go straight through the next traffic light (Country Club Lane); turn into the main entrance of Union University, which will be the next right off Pleasant Plains.

### **Eastbound Interstate 40 to Exit 80B (from Memphis):**

After you take exit 80b off of I-40 you will be going north on U.S. 45 Bypass. Immediately take the Vann Drive exit ramp off of U.S. 45 Bypass. Turn left at the light onto Vann Drive. Go through one traffic light. Go past Perkins Restaurant and Red Robin. Turn right at the second light onto Pleasant Plains. Go straight through the next traffic light (Country Club Lane); turn into the main entrance of Union University, which will be the next right off Pleasant Plains.

### **Southbound on U.S. 45 Bypass:**

Proceed southward through the Oil Well Road and Union University Drive intersections. Past the LifeWay building and the Union University soccer fields on your right is an exit for Country Club Lane. Take that exit and look for the south entrance to campus, which is on the right. Follow the drive past the soccer fields. On the left is a baseball field. At the end of that field, turn left and drive in the direction of Miller Tower.

### **Northbound on U.S. 45 Bypass:**

After you take exit 80b off of I-40 you will be going north on U.S. 45 Bypass. Immediately take the Vann Drive exit ramp off of U.S. 45 Bypass. Turn left at the light onto Vann Drive. Go through one traffic light. Go past Perkins Restaurant and Red Robin. Turn right at the second light onto Pleasant Plains. Go straight through the next traffic light (Country Club Lane); turn into the main entrance of Union University, which will be the next right off Pleasant Plains.

This is a map of the entire Union University campus. Most of the conference will be in Building #5.  
For more specific instructions refer to the map on the back of this page.

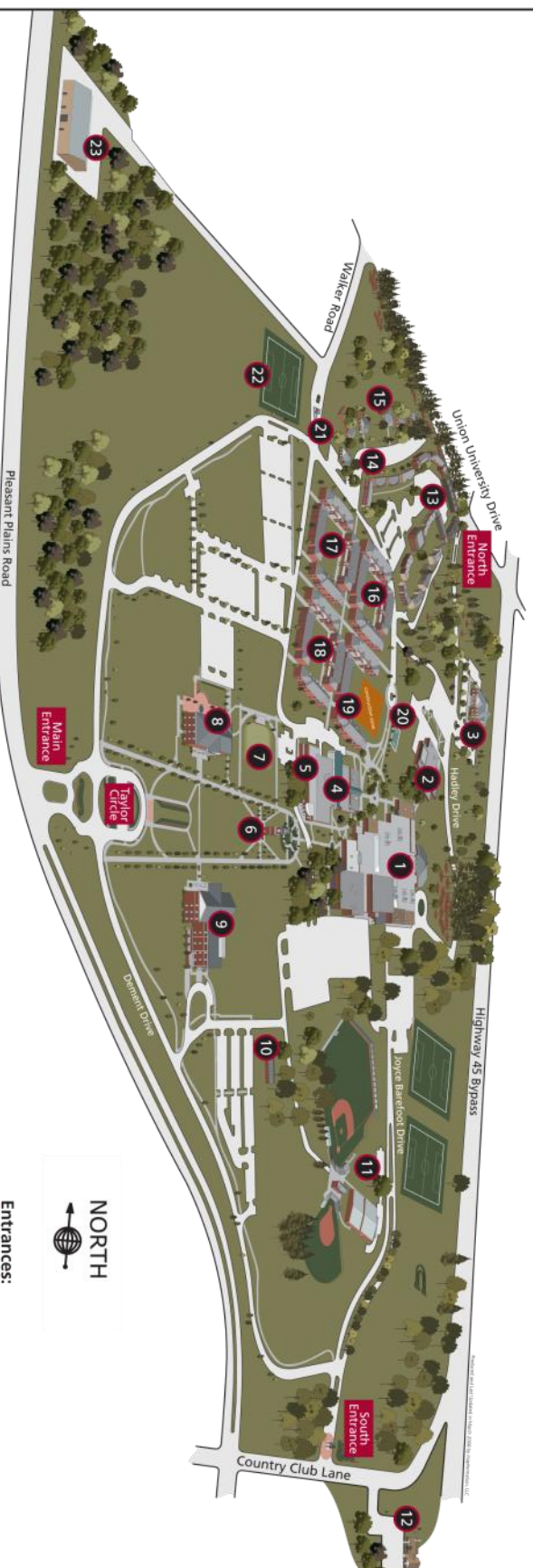

## CAMPUS FACILITIES

1. **Penick Academic Complex**
  - a. Savage Chapel
  - b. Powell Theatre
  - c. Summar Library
  - d. Delay Gymnasium
  - e. Palmer Activities Center/ Williams Aquatic Center
  - f. Administrative Offices
  - g. Union Station
  - h. Art Gallery
  - i. Career Services
  - j. College of Arts and Sciences
  - k. School of Pharmacy
2. **Blasingame Academic Complex**
  - l. College of Education and Human Studies
  - m. McAfee School of Business Administration
3. **Hammons Hall**
  - n. LifeWay Christian Store
  - o. Advancement and Alumni Offices
  - p. Continuing Studies
4. **Barefoot Student Union Building**
  - q. Student Life Offices
  - r. Harvey Hall
  - s. Post Office
  - t. University Services
  - u. Undergraduate Admissions and Financial Aid
  - v. Student Dining Hall
  - w. Lexington Inn
  - x. Barefoot's Joe
5. **Carl Grant Events Center**
  - y. Heritage Center
  - z. Banquet Hall
6. **Miller Tower**
7. **Amphitheatre**
8. **Jennings Hall**
  - aa. School of Christian Studies
  - bb. Departments of Music and Communication Arts
9. **White Hall**
  - cc. School of Nursing
  - dd. Departments of Biology and Chemistry
10. **Photo House**
11. **Fesquire Field House and Press Box**
  - ee. Soccer Fields
  - ff. Baseball/Softball Fields
12. **Luther Hall**
13. **Church Relations Office**
14. **Heritage Residence Complex**
  - hh. McAfee Commons
15. **Warmath Family Housing**
16. **Fraternity Row**
17. **Ayers Residence Complex**
18. **Hurt Residence Complex**
19. **Watters Residence Complex**
20. **Grace Residence Complex**
21. **Outdoor Basketball Court**
22. **The Welcome House**
23. **Intramural Fields**
23. **Facilities Management**

### Entrances:

Pleasant Plains Entrance (West-Main)  
Union University Drive Entrance (North)  
Country Club Lane (South)  
Walker Road (Welcome House)



1050 Union University Drive  
Jackson, Tennessee 38305  
731.668.1818 | [www.uu.edu](http://www.uu.edu)

WORD  
WITHIN THE  
WORD

# Instructions for Parking, Registration, and Locations

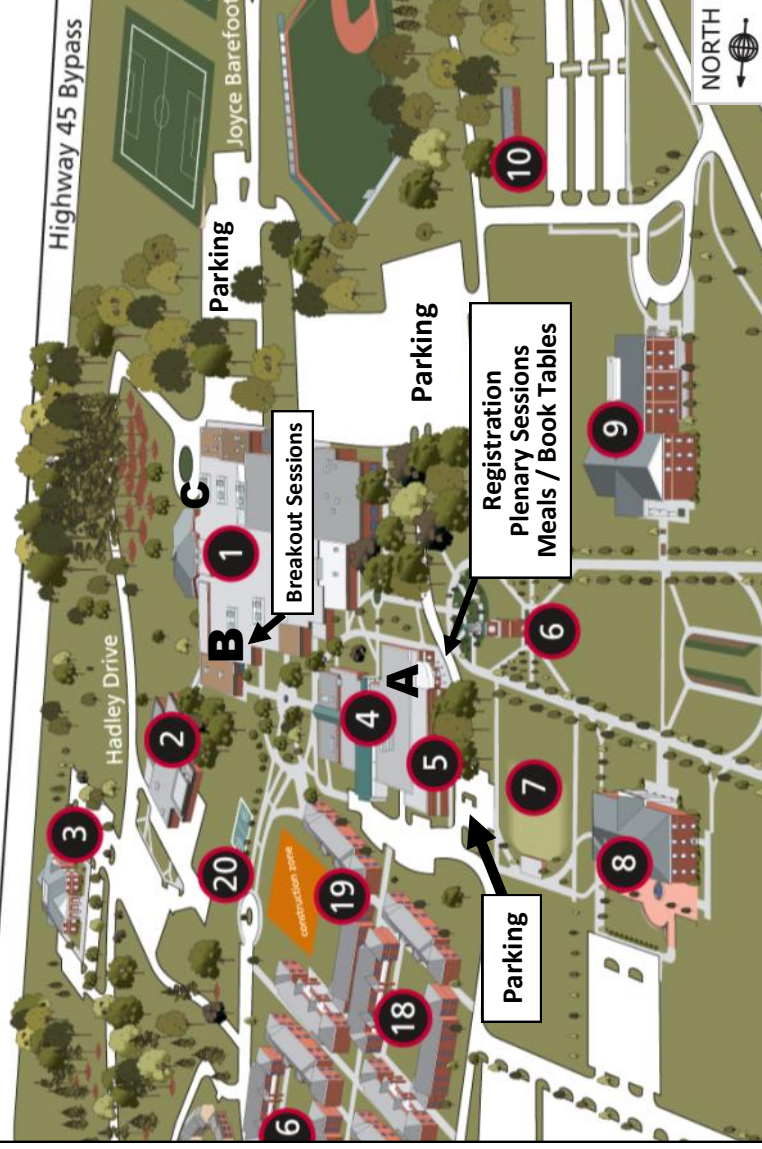

## UNION UNIVERSITY

### Map Legend

1. Penick Academic Complex
  - B. Breakout Session Classrooms
    - C. Circle Drive (dropoff/pickup)
  - Blasingame Academic Complex
  - LifeWay Store / Hammons Hall
  - Barefoot Student Union Building
5. Grant Events Center
  - A. Entrance / Registration
6. Miller Tower
7. Amphitheater
8. Jennings Hall
9. White Hall
10. Photography House
18. Watters Residence Complex
19. Grace Residence Complex
20. Outdoor Basketball Court

**Parking:** We suggest that you park in any of the three parking lots labeled on this map. (No parking permit will be needed.)

**Registration/Drop Off:** Registration is in the Grant Events Center (building #5) The **entrance** is marked on here with a large “A”.

**Plenary Sessions (Dr. Carson):** All of the plenary sessions (main sessions) will take place in the Grant Events Center (building #5).

**Meals:** All of the meals will take place in the Grant Events Center (building #5).

**Breakout Sessions:** All of the Breakout Sessions are in the Penick Academic Complex (building #1), specifically at point “B”.

**Special Assistance:** If you anticipate trouble walking from the Grant Events Center (Point A) to the classrooms in Penick Academic Complex (Point B) you may want to have someone drive you from Point A to Point C where you can be dropped off closer to the actual classrooms. Point C is just outside of the Savage Memorial Chapel on the far eastern side of the Penick Academic Complex (building #1) (Please do not *park* in the circle at Point C.)

## **Friday**

*All of the Friday activities will take place in the Grant Events Center (Building #5 on map)*

### **4:30 – 6:00 pm Registration**

Upon arrival on Friday afternoon you may check in at the registration desk located in the lobby of the Grant Events Center. Here you will find a packet of information and a name tag for you. (Your name tag will serve as your meal ticket for the meals on Friday and Saturday.) You will also find book tables and other displays.

### **6:00 – 7:15 pm Banquet Dinner (hosted by B&H Publishing)**

At 6:00 pm on Friday we will eat in the banquet hall of the Grant Events Center. During this meal there will be an official welcome and introductions.

### **7:30 – 8:45 pm Plenary 1 (D.A. Carson)**

After the meal and a short break we will enjoy the first plenary address by Dr. D.A. Carson. This will also take place in the banquet hall of the Grant Events Center. The completion of this address will conclude our evening.



# Saturday

**SPECIAL NOTICE: The Saturday schedule begins in the Penick Academic Complex (building #1 on map),**

**NOT in the Grant Events Center (building #5 on map).**

<p>Penick Academic Complex</p> <p>(building #1 on map)</p>	<p><b>8:00 – 8:30 am <u>Continental Breakfast</u></b></p> <p>If you would like you may arrive at 8:00 am for a light continental breakfast before the first session. Selections will include pastries, fruit, coffee, and juice. Simply follow the signs in the Penick building to the breakfast area.</p> <p><b>8:30 – 9:30 am <u>Breakout Sessions</u></b></p> <p>Our conference will resume on Saturday morning with the first Breakout Sessions at 8:30. All of the breakout sessions will take place in the classrooms of the Penick Academic Complex (Building #1 on map).</p> <p><b>(9:30—9:45 am BREAK)</b></p> <p><b>9:45 – 10:45 am <u>Breakout Sessions</u> *</b></p> <p><b><u>* Please note the time change from the original conference brochure.</u></b></p> <p>After this breakout session please proceed from the Penick Academic Complex to the Grant Events Center (same location as the Friday banquet). Restrooms are available in both areas.</p>
<p>Grant Events Center</p> <p>(building #5 on map)</p>	<p><b>11:00 – 12:00 <u>Plenary 2 (D.A. Carson)</u> *</b></p> <p><b><u>* Please note the time change from the original conference brochure.</u></b></p> <p>Dr. Carson’s second plenary address will take place in the same area as the banquet and the first plenary address the night before.</p> <p><b>12:15 – 1:15 pm <u>Lunch</u> (Book Tables open)</b></p> <p>After lunch please return to the Penick Academic Complex for the 1:30 breakout sessions.</p>
<p>Penick Academic Complex</p>	<p><b>1:30 – 2:30 pm <u>Breakout Sessions</u></b></p> <p>As this breakout session concludes please return to the Grant Events Center for our final event.</p>
<p>Grant Events Center</p>	<p><b>2:45 – 4:00 pm <u>Plenary 3 (D.A. Carson)</u></b></p> <p>At the conclusion of this address our conference will be complete.</p>

# WORD WITHIN THE WORD

# Breakout Session Speakers & Topics

Each of these breakout session leaders will be giving the *same* presentation three times on Saturday (8:30, 9:45, & 1:30) so you can pick three *different* sessions to attend.

**IMPORTANT NOTE:** The only **exception** will be the sessions on children's bible study led by David and Sally Michael who will be providing a *different presentation in each of the three* time slots. Those interested in the topic of children's bible study may choose to attend any or all of the Michael's presentations.



## "Eschatology and Ethics: Envisioning the Christian Life Without a Bracelet"

**Justin Barnard** is the Director of the Carl F.H. Henry Institute for Intellectual Discipleship and an Associate Professor of Philosophy at Union University. Barnard received an M.A. and Ph.D. in Philosophy from Florida State University after completing his undergraduate degree at Palm Beach Atlantic University.



## "Theological Themes in the book of Malachi"

**Ray Clendenen** is director of academic publishing at B&H Publishing (Broadman & Holman), general editor of the New American Commentary series, and associate general editor of the *Holman Christian Standard Bible* translation. Clendenen received a Ph.D. from the University of Texas at Arlington. He has co-written several books including *Haggai-Malachi* (New American Commentary).



## "Observation Skills: Laying an Essential Foundation for Biblical Interpretation"

**Mark Dubis** is Associate Professor of Christian Studies at Union University. He received a Master of Divinity degree from Gordon-Conwell Theological Seminary, a Master of Theology degree from Calvin Theological Seminary, and a Ph.D. from Union Theological Seminary.



## "From Promises to Reality: How Christianity Fulfills the Ancient Plan God Promised"

**Ken Easley** is Professor of Christian Studies at Union University and Director of the Master of Christian Studies Program at Union University's Stephen Olford Center in Memphis, TN. He holds a Master of Divinity degree from Trinity Evangelical Divinity School in Deerfield, Illinois and a Ph.D. from Southwestern Baptist Theological Seminary in Fort Worth, TX.



## "Salvation and Works in the Old and New Testaments"

**Brad Green** is Associate Professor of Christian Studies (Theology) at Union University. Green holds masters degrees from both The Southern Baptist Theological Seminary in Louisville, Kentucky and Southwestern Baptist Theological Seminary in Fort Worth, Texas. His Ph.D. is from Baylor University in Waco, Texas.



## "How to Do Biblical Word Studies"

**George Guthrie** is the Benjamin W. Perry Professor of Bible at Union University. Guthrie holds both the M.Div. and Ph.D. from Southwestern Baptist Theological Seminary and a Th.M. from Trinity Evangelical Divinity School. He serves as Senior Fellow of the Ryan Center for Biblical Studies and was instrumental in its creation. His many works include *Hebrews* (NIV Application Commentary).



## "Psalm 22 in the Words of Jesus"

**Paul Jackson** is Professor of Christian Studies at Union University. Jackson did his undergraduate study at Hardin-Simmons University and received the M.Div. and Ph.D. from Southwestern Baptist Theological Seminary in Fort Worth, Texas.



## 8:30 am- "God-Centered Bible Teaching for the Glory of God"

## 9:45 am- "Raising Bible-Saturated Children"

## 1:30 pm- "Aiming for Application and Response in Teaching Children the Bible"

**David & Sally Michael** are the directors of Parenting and Children's Discipleship at Bethlehem Baptist Church in Minneapolis, Minnesota. They are authors of children's bible study curricula for "Children Desiring God".

(Continued on back...)

# WORD WITHIN THE WORD

# Breakout Session Speakers & Topics

Each of these breakout session leaders will be giving the *same* presentation three times on Saturday (8:30, 9:45, & 1:30) so you can pick three *different* sessions to attend.

**IMPORTANT NOTE:** The only **exception** will be the sessions on children's bible study led by David and Sally Michael who will be providing a *different presentation in each of the three* time slots. Those interested in the topic of children's bible study may choose to attend any or all of the Michael's presentations.

	<p><b>"Preaching an Old Covenant Text as a New Covenant Preacher"</b></p> <p><b>David Olford</b> is the Stephen Olford Professor of Expository Preaching and Assistant to the President at Union University. Olford received his undergraduate and masters degrees from Wheaton College and his Ph.D. from the University of Sheffield in England. He recently published <i>Find Us Faithful: Leadership That Leaves a Legacy</i> (B&amp;H, 2009).</p>		<p><b>"Church History and the Interpretation of Scripture"</b></p> <p><b>James (Jim) Patterson</b> is Professor of Christian Studies (Church History) at Union University and serves as Associate Dean of the School of Christian Studies. He received a Master of Divinity degree from Gordon-Conwell Theological Seminary and a Ph.D. from Princeton Theological Seminary.</p>
	<p><b>"The OT and NT Identification of the 'Servant' in Isa 42:1-13"</b></p> <p><b>Gary Smith</b> is Professor of Christian Studies (Old Testament) at Union University. Smith received a B.A. from Wheaton College, a Masters degree from Trinity Evangelical Divinity School and a Ph.D. from Dropsie College. He has authored <i>Isaiah 1-39</i> in the New American Commentary series and <i>Hosea, Amos, Micah</i> in the NIV Application Commentary Series.</p>		<p><b>"Paul's Worldview Apologetic in Acts 17"</b></p> <p><b>Greg Spears</b> serves as Church Leadership Development Specialist in the Mid-South Baptist Association (Memphis, TN area). Before joining the staff of the Mid-South Baptist Association, he was a church planter in the inner-city of Memphis, Tennessee. He holds a Master of Divinity and Ph.D. from Mid-America Baptist Theological Seminary in Cordova, Tennessee.</p>
	<p><b>"Using the Psalms in Pastoral Prayer"</b></p> <p><b>Richard Wells</b> is Dean of the Chapel and Professor of Christian Studies at Union University. Wells holds two masters degrees (Criswell College, Stetson University) and two Ph.D.'s, one from Baylor University and one from North Texas University. He is a former president of Criswell College in Dallas, Texas.</p>		<p><b>"Paul's Use of the OT in Romans 15:1-13"</b></p> <p><b>Terry Wilder</b> is the Academic Acquisitions Editor for B&amp;H Publishing (Broadman &amp; Holman) in Nashville, Tennessee, where he lives with his wife Denise and their two boys, Ian and Aaron. He is also Research Professor of New Testament and Greek at Midwestern Baptist Theological Seminary in Kansas City, Missouri.</p>
	<p><b>"Seeing the Psalms in the New Testament"</b></p> <p><b>Taylor Worley</b> is an Instructor of Christian Studies and a recent addition to the faculty of Union University. His doctoral work has taken place at the University of St. Andrews in Scotland in the field of theological aesthetics. He received a Master of Divinity degree from the Southern Baptist Theological Seminary in Louisville, KY.</p>		<p><b>"Bible Software Demonstration &amp; Training"</b></p> <p><b>Logos Bible Software</b> representative Kendall Stellfox will demonstrate the latest in electronic bible study. Logos Research Systems, Inc. is the largest developer of Bible software. They partner with more than 100 publishers to make more than 9,000 electronic Bible study resources available to customers around the world. Their technology is used in more than 180 countries in a dozen languages.</p>